

Aesculap® Single Use Surgical Instruments

Procedure Sets
Instruments for Ward Use and Emergency Care



Aesculap Surgical Technologies

*A new Standard in
Surgical Instruments*

B | BRAUN
SHARING EXPERTISE

Aesculap® SUSI®

Single Use Surgical Instruments



PACK PER CASE

Pack per case – Procedure sets

„All inclusive“: – high quality single use instrumentation
– all required consumables

At your finger tips! Ready for use when required:

- instantly available
- always complete
- always sterile (sterilised in acc. to validated sterilisation process)
- reliable
- procedure related cost transparency
- no additional service cost (e.g. repair cost, etc..)
- always up-to-date

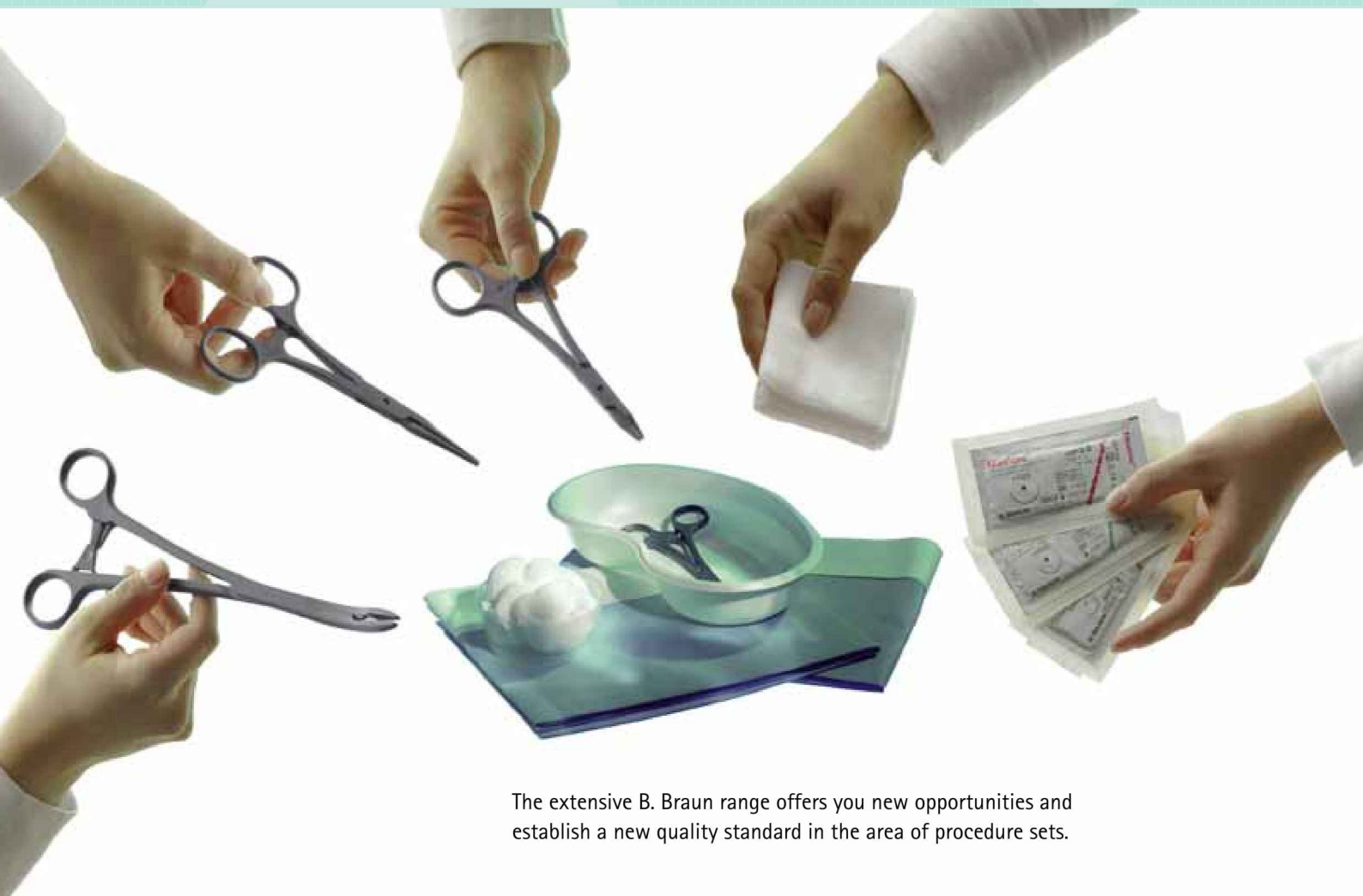

The extensive B. Braun range offers you new opportunities and establish a new quality standard in the area of procedure sets.



Pack per case – The special set

B. Braun Aesculap procedure sets make a difference, independently if used for small procedures or for treatment of large wounds. Our "Pack per case" range of procedure sets include all the single use products which hospitals, clinics and practitioners rely upon every day. However the surgical instruments in the sets make the difference. They are high performance precision instruments, although designed for single use. No wonder, Aesculap instruments represent quality, security and reliability since generations.

The choice is yours – Establish a new standard

"Pack per case" procedure sets have proven their suitability on hospital wards, in intensive care units, A&E Departments, Outpatient Departments, Nursing homes, GP surgeries & practices and can also be used by ambulance services. For all these areas of application, SUSI procedure sets not only offer medical advantages but also plenty of savings potential. Should you have specific needs and requirements (i.e custom made sets or economic analysis) please do not hesitate to contact us.

SUSI – The difference

SUSI (Single Use Surgical Instruments) Instrumentation is a completely unique range of single use surgical instruments. Utilising proven established design patterns and the use of light high performance polymers for the production provides you with high precision instruments with excellent mechanical properties. The material used allows simple, secure and environmentally friendly incineration utilising existing disposal systems in hospitals.

SUSI instruments are also available individually sterile packed in a dispenser box.

Aesculap® SUSI®

Single Use Surgical Instruments

5061000 Suture Set 1



5061010 Surgical Dressing Set 1



| Contents | Pieces |
|---|--------|
| Defix kidney tray, white | 1 |
| Bowl, transparent, 120 ml | 1 |
| Gauze swabs, plumsized | 5 |
| SUSI forceps Adson, sharp, 120 mm | 1 |
| SUSI needle holder Mayo-Hegar, 150 mm | 1 |
| SUSI scissors, sharp/blunt, 145 mm | 1 |
| SUSI haemostatic forceps Pean, straight, 145 mm | 1 |
| Order unit: PAK = Pack of 20 sets | |

| Contents | Pieces |
|--|--------|
| Defix kidney tray, white | 1 |
| Bowl, transparent, 120 ml | 1 |
| Gauze compress, 7.5 x 7.5 cm, 8-fold (ply) | 5 |
| Gauze swabs, plumsized | 5 |
| SUSI forceps Adson, sharp, 120 mm | 1 |
| SUSI needle holder Mayo-Hegar, 150 mm | 1 |
| SUSI scissors, sharp/blunt, 145 mm | 1 |
| Order unit: PAK = Pack of 20 sets | |

5061020 Surgical Dressing Set 2



| Contents | Pieces |
|---|--------|
| Defix kidney tray, white | 1 |
| Bowl, transparent, 120 ml | 1 |
| Drape, 75 x 90 cm | 1 |
| Hole towel, 75 x 75 cm, adhesive area | 1 |
| Gauze compress, 7.5 x 7.5 cm, 12-fold (ply) | 10 |
| Gauze swabs, plumsize | 5 |
| SUSI forceps Adson, sharp, 120 mm | 1 |
| SUSI needle holder Mayo-Hegar, 150 mm | 1 |
| SUSI scissors, sharp/blunt, 145 mm | 1 |
| SUSI haemostatic forceps Pean, straight, 145 mm | 1 |
| Order unit: PAK = Pack of 20 sets | |

5061030 Surgical Dressing Set 3



| Contents | Pieces |
|--|--------|
| Defix kidney tray, white | 1 |
| Bowl, transparent, 120 ml | 1 |
| Gauze compress, 7.5 x 7.5 cm, 8-fold (ply) | 5 |
| Gauze swabs, plumsize | 5 |
| SUSI tissue forceps, sharp, 145 mm | 1 |
| SUSI scissors, sharp/blunt, 145 mm | 1 |
| Order unit: PAK = Pack of 20 sets | |

Aesculap® SUSI®

Single Use Surgical Instruments

5061040 Suture Removal Set 1



| Contents | Pieces |
|------------------------------------|--------|
| Cardboard tray, 180 x 90 x 17 mm | 1 |
| Mini compress, 25 x 25 mm | 17 |
| SUSI forceps, sharp, 120 mm | 1 |
| SUSI scissors, sharp/sharp, 110 mm | 1 |
| Order unit: PAK = Pack of 20 sets | |

5061050 Suture Removal Set



| Contents | Pieces |
|---|--------|
| Defix kidney tray, white | 1 |
| Cutfix Stitch Cutter | 1 |
| Gauze compress, 5 x 5 cm, 8-fold (ply) | 2 |
| SUSI dissecting forceps Adson, fine, 120 mm | 1 |
| Order unit: PAK = Pack of 20 sets | |

5062000 Thorax Drainage Set, small



| Contents | Pieces |
|---|--------|
| Plastic tray, blue | 1 |
| Vasco surgical gloves, size 7.5 | 1 |
| Drape, 45 x 75 cm | 1 |
| Hole towel, 75 x 110 cm, blue | 1 |
| Gauze compress with slit, 10 x 10 cm, 12-fold (ply) | 2 |
| Gauze compress, 10 x 10 cm, 12-fold (ply) | 5 |
| Disposable scalpel size 11 | 1 |
| SUSI Metzenbaum dissecting scissors, curved, 180 mm | 1 |
| SUSI needle holder Mayo-Hegar, 150 mm | 1 |
| SUSI tubing clamp, 135 mm | 1 |
| Suture Premilene 2/0, 75 cm, DS39 (M) | 2 |
| Order unit: PAK = Pack of 5 sets | |

Aesculap® SUSI®

Single Use Surgical Instruments

5062010 Thorax Drainage Set, large



| Contents | Pieces |
|---|--------|
| Plastic tray, 64 x 38 x 3 cm | 1 |
| Drape, 75 x 90 cm | 1 |
| Surgical gloves, size 7.5, powder free | 1 |
| Gauze compress, 10 x 10 cm, 12-fold (ply) | 8 |
| Slit compress, 10 x 10 cm, 12-fold (ply) | 2 |
| Bowl, round, 250 ml | 1 |
| SUSI dressing forceps, curved, 265 mm | 1 |
| Drape, 75 x 100 cm, self adhesive | 2 |
| Injection syringe, Luer, 10 ml | 1 |
| Sterican cannula size 1, G 20 x 1 1/2, Ø 0.90 mm, 40 mm, yellow | 1 |
| Sterican cannula, LL, G 18 x 1 1/2, Ø 1.20 mm, 40 mm, pink | 1 |
| Sterican cannula, LL, G 20 x 2 3/4, Ø 0.90 mm, 70 mm, yellow | 1 |

| Contents | Pieces |
|--|--------|
| Sterican cannula size 12, G 22 x 1 1/4, Ø 0.70 mm, 30 mm, black | 1 |
| Disposable scalpel size 11 | 1 |
| SUSI tissue forceps, sharp, 145 mm | 1 |
| SUSI Metzenbaum dissecting scissors, 180 mm | 1 |
| SUSI needle holder Mayo-Hegar, 150 mm | 1 |
| SUSI tubing clamp, 135 mm | 1 |
| Suture Premicron green 0 (3.5), 75 cm, DS 30 (M) | 1 |
| Suture Dafilon blue 3/0 (2), 75 cm, 1 x DS 19 | 1 |
| Askina fix fixation plaster, 15 x 20 cm | 2 |
| Order unit: PAK = Pack of 5 sets | |
| Developed in cooperation with: Dr. med. Thomas Kiefer, Klinikum Offenburg, Ebertplatz 12, 77654 Offenburg, Germany | |

5062020 Thorax Drainage Set



| Contents | Pieces |
|---|--------|
| Plastic Tray, light blue, 250 x 137 x 57 mm | 1 |
| Hole towel, 75 x 110 cm, blue | 1 |
| Askina fix fixation plaster, 15 x 20 cm | 1 |
| Slit compress, 10 x 10 cm, 12-fold (ply) | 2 |
| Gauze compress, 12-fold (ply), 10 x 10 cm | 5 |
| SUSI sponge forceps, curved, 200 mm | 1 |
| SUSI tissue forceps, 1 x 2 teeth, 145 mm | 1 |
| SUSI dissecting scissors Metzenbaum, curved, 180 mm | 1 |
| SUSI needleholder Mayo-Hegar, straight, 150 mm | 1 |
| SUSI tubing clamp, 135 mm | 1 |
| Disposable scalpel size 11 | 1 |
| Single use razor | 2 |
| Injection syringe, Luer, 10 ml | 1 |

| Contents | Pieces |
|--|--------|
| Sterican cannula size 1, G 20 x 1 1/2, Ø 0.90 mm, 40 mm yellow | 1 |
| Sterican cannula size 12, G 22 x 1 1/4, Ø 0.70 mm, 30 mm black | 1 |
| Sterican cannula, deep intra-muscular, LL G 20 x 2 3/4, Ø 0.90 mm, 70 mm, yellow | 1 |
| Drape 78 x 90 cm | 1 |
| Suture Premilene 2/0 (3) 75 cm, DS39 (M) | 2 |
| Suture Dagrofil green 0 (3.5) 75 cm, 1 x DS30 | 1 |
| Order unit: PAK = Pack of 5 sets | |

Aesculap® SUSI®

Single Use Surgical Instruments

5063000 SUSI Port Set



| Contents | Pieces |
|---|--------|
| Struma-Drape, T-Form, 198/259 x 30 cm | 1 |
| Tray 28 x 38 x 3 cm | 1 |
| Sterican cannula size 2, G 21 x 1 1/2, Ø 0.80 mm, 40 mm, green | 1 |
| Sterican cannula size 12, G 22 x 1 1/4, Ø 0.70 mm, 30 mm, black | 1 |
| Disposable scalpel size 10 | 1 |
| Disposable electrode handle | 1 |
| Suture Safil violet 3/0 (2) 70 cm, HR26 | 2 |
| Suture Monosyn undyed 4/0 (1.5) 45 cm, 1 x DSM19 | 1 |
| Injection syringe, Luer, 10 ml | 2 |
| Askina Soft steril, 9 x 10 cm | 1 |
| SUSI dissecting forceps Adson, fine, 120 mm | 1 |
| SUSI tissue forceps, 1 x 2 teeth, 145 mm | 2 |
| SUSI dissecting scissors Metzenbaum, curved, 180 mm | 1 |

| Contents | Pieces |
|--|--------|
| SUSI needleholder, Mayor-Hegar, 150 mm | 1 |
| SUSI self-retaining retractor Weitlaner, 3 x 4 teeth, 130 mm | 1 |
| SUSI retractor Roux, 170 mm | 1 |
| Gauze compress, 16-fold (ply), 10 x 10 cm, X-ray marker | 20 |
| Operation gown, 130 cm | 3 |
| Tablebag, 75 x 141 cm | 1 |
| Cover drape, 152 x 193 cm | 1 |
| Order unit: PAK = Pack of 5 sets | |

5063010 SUSI Cardiac Pacemaker Set



| Contents | Pieces |
|---|--------|
| Cover drape 236 x 300 cm, with slit 9 x 108 cm | 1 |
| Anesthesia drape 152 x 250 cm | 1 |
| Cover drape, self-adhesive, 75 x 90 cm | 2 |
| C-Bend cover 70 + 43 x 200 cm | 1 |
| Tray, 33 x 30 x 6 cm, white | 1 |
| Bowl round, 250 ml, light blue | 1 |
| Gauze swabs, round, 40 x 40 cm, X-ray marker | 5 |
| Gauze compress, 12-fold (ply), 10 x 10 cm, X-ray marker | 20 |
| Disposable scalpel size 22 | 1 |
| Omnifix injection syringe, Luer, Lock, 20 ml | 1 |
| Sterican cannula size 1, G 20 x 1 1/2, Ø 0.90 mm, 40 mm, yellow | 1 |
| Sucker bag 33 x 41 cm, 2 chambers, self-adhesive | 1 |
| Disposable electrode handle | 1 |
| SUSI Mosquito forceps, curved, 125 mm | 2 |
| SUSI dissecting scissors Metzenbaum, curved, 180 mm | 1 |

| Contents | Pieces |
|--|--------|
| SUSI haemostatic forceps Birkett, curved, 185 mm | 2 |
| SUSI needleholder Crile Wood, straight, 200 mm | 1 |
| SUSI tissue forceps Waughs, 200 mm | 1 |
| SUSI sponge forceps, curved, 265 mm | 1 |
| SUSI dissecting forceps Cushing, 200 mm | 1 |
| SUSI self-retaining retractor Weitlaner, 3 x 4 teeth, 130 mm | 1 |
| SUSI retractor Roux, 170 mm | 1 |
| Bowl, round, 120 ml, transparent | 2 |
| Askina Soft 9 x 10 cm | 1 |
| Suture Monosyn violet 3/0 (2), 70 cm, HR26 | 1 |
| Suture Monosyn undyed 4/0 (1.5), 70 cm, DSMP24 | 1 |
| Suture Silkam black 0 (3.5), 75 cm, 1 x HR26 | 1 |
| Operation gown, 130 cm | 2 |
| Table bag, 75 x 141 cm | 1 |
| Table cover, 152 x 193 cm | 1 |
| Order unit: PAK = Pack of 4 sets | |

Aesculap® SUSI®

Single Use Surgical Instruments

5063020 SUSI Varicose Veins Set



| Contents | Pieces |
|---|--------|
| Anesthesia drape, 183 x 300 cm | 1 |
| U-Drape, 196 x 295 cm | 1 |
| Cover drape, 102 x 150 cm | 1 |
| 3-Pocket tray, 24 x 25 x 5 cm | 1 |
| Suture collector, 4 pockets | 1 |
| Preparation swab ball, middle, size 2, X-ray marker | 5 |
| Gauze swabs, plumsize, round, 20 x 20 cm, X-ray marker | 10 |
| Gauze compress, 16-fold (ply), 10 x 10 cm, X-ray marker | 20 |
| Disposable scalpel size 11 | 1 |
| Askina Elast fixation bandage, 4 m x 12 cm | 1 |
| Askina Soft sterile, 7,5 x 5 cm | 8 |
| Askina Soft sterile, 9 x 10 cm | 1 |
| Askina universal bandage 5 m x 8 cm | 1 |

| Contents | Pieces |
|--|--------|
| Askina universal bandage 5 m x 10 cm | 2 |
| Suture Safil violet 3/0 (2) 6 x 45 cm | 1 |
| Suture Safil violet 0 (3.5) 70 cm, HR30 | 1 |
| Suture Monosyn undyed 4/0 (1.5) 45 cm, DS19 | 1 |
| Suture Monosyn undyed 4/0 (1.5) 70 cm, DS19 | 1 |
| SUSI needleholder Crile Wood, straight, 200 mm | 1 |
| SUSI tissue forceps Adson, fine, 120 mm | 1 |
| SUSI dissecting forceps Adson, fine, 120 mm | 1 |
| SUSI Mosquito forceps, straight, 125 mm | 3 |
| SUSI Mosquito forceps, curved, 125 mm | 1 |
| SUSI dissecting scissors Metzenbaum, curved, 180 mm | 1 |
| SUSI self-retaining retractor Weitlaner, 3 x 4 teeth, 130 mm | 1 |
| SUSI retractor Roux, 170 mm | 1 |

| Contents | Pieces |
|--|--------|
| Abdominal drape, 6 ply, white, 45 x 45 cm, X-ray marker | 5 |
| Venostrip Vein exstirpations-set | 1 |
| Operation gown, 130 cm | 3 |
| Tablebag, 75 x 141 cm | 1 |
| Surgical gloves, size 8, powder free | 1 |
| Cover drape, 152 x 193 cm | 1 |
| Order unit: PAK = Pack of 4 sets | |

Aesculap® SUSI®

Single Use Surgical Instruments



CLINIC LINE

A new standard for surgical instruments

SUSI (Single Use Surgical Instruments) is a totally unique range of surgical instruments. With SUSI you get the highest level of innovation and performance in a new but at the same time familiar and proven design. SUSI instruments are manufactured from a light, high performance polymer. The special composition of this polymer ensures outstanding accuracy and offers excellent mechanical characteristics.

In developing SUSI ClinicLine, we have focussed in particular on the requirements on the ward and in outpatient departments. In these areas it is essential to have sterile, functional and safe surgical instruments available quickly and at low process costs. With SUSI ClinicLine we can offer you the right solution.



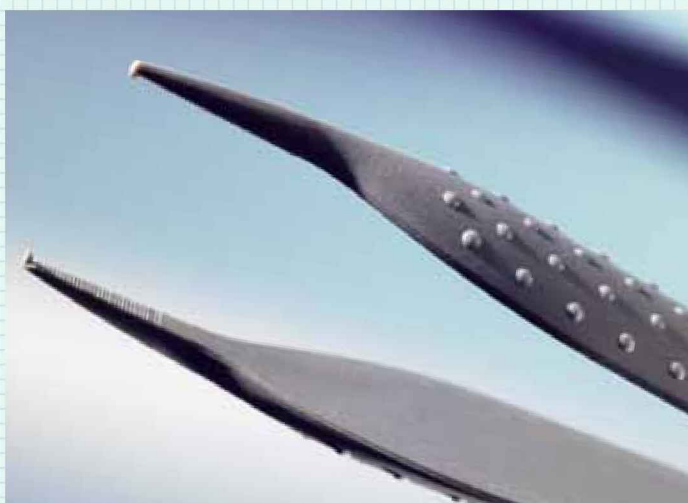

SUSI helps you in your daily work with many positive features and advantages

Safety

SUSI protects against the risk of cross-contamination through surgical instruments.

Quality assurance

- With SUSI you always have a new instrument which ensures 100% functionality for the intended use
- SUSI will be supplied sterile packed and are sterilised in a validated process

Economical Aspects

- SUSI provides a clear cost allocation according to DRGs
- SUSI leads to a reduction of processing costs in the hospital

Material

SUSI are made from a high performance polymer. The special composition of this high-grade polymer ensures an outstanding quality and provides optimal mechanical properties for the intended function of each instrument. This material ensures a safe, easy and environmentally friendly removal through incineration in the regular hospital waste removal system.

Packaging

SUSI are sterile packed in single peel packs. The single peel packs are presented in dispenser boxes containing an indicated quantity of units as described in this leaflet.



Aesculap® SUSI®

Single Use Surgical Instruments



| AN915SU | SUSI Tubing Clamp |
|------------|--|
| Dimension | 135 mm, 5 5/16" |
| Sales Unit | 20 pieces, sterile, single packed in dispenser box |



| BF046SU | SUSI Sponge Forceps |
|-------------|--|
| Name | GROSS |
| Description | straight, with universal ratchet |
| Dimension | 200 mm, 8" |
| Sales Unit | 20 pieces, sterile, single packed in dispenser box |



| BF059SU | SUSI Sponge Forceps |
|-------------|--|
| Description | curved, with universal ratchet |
| Dimension | 265 mm, 10 1/2" |
| Sales Unit | 20 pieces, sterile, single packed in dispenser box |



| BF047SU | SUSI Sponge Forceps |
|-------------|--|
| Name | GROSS |
| Description | curved, with universal ratchet |
| Dimension | 200 mm, 8" |
| Sales Unit | 20 pieces, sterile, single packed in dispenser box |

Aesculap® SUSI®

Single Use Surgical Instruments



| BC110SU | SUSI Fine Scissors |
|-------------|--|
| Description | sh/sh, straight |
| Dimension | 110 mm, 4 3/8" |
| Sales Unit | 20 pieces, sterile, single packed in dispenser box |



| BC324SU | SUSI Surgical Scissors |
|-------------|--|
| Description | sh/bl, straight |
| Dimension | 145 mm, 5 3/4" |
| Sales Unit | 20 pieces, sterile, single packed in dispenser box |



1/1

| BC606SU | SUSI Dissecting Scissors |
|-------------|---|
| Name | METZENBAUM |
| Description | curved |
| Dimension | 180 mm, 7" |
| Sales Unit | 20 pieces, sterile, single packed in dispenser box |

Aesculap® SUSI®

Single Use Surgical Instruments



1/1

| BD222SU | SUSI Dissecting Forceps |
|-------------|--|
| Name | ADSON |
| Description | w/o teeth, fine |
| Dimension | 120 mm, 4 3/4" |
| Sales Unit | 20 pieces, sterile, single packed in dispenser box |



1/1

| BD512SU | SUSI Tissue Forceps |
|-------------|--|
| Name | ADSON |
| Description | 1 x 2 teeth, fine |
| Dimension | 120 mm, 4 3/4" |
| Sales Unit | 20 pieces, sterile, single packed in dispenser box |



1/1



1/1

| BD047SU | SUSI Dissecting Forceps |
|-------------|--|
| Description | w/o teeth |
| Dimension | 145 mm, 5 3/4" |
| Sales Unit | 20 pieces, sterile, single packed in dispenser box |

| BD557SU | SUSI Tissue Forceps |
|-------------|--|
| Description | 1 x 2 teeth |
| Dimension | 145 mm, 5 3/4" |
| Sales Unit | 20 pieces, sterile, single packed in dispenser box |

Aesculap® SUSI®

Single Use Surgical Instruments



3/4

| BD239SU | SUSI Dissecting Forceps |
|-------------|--|
| Name | CUSHING |
| Description | serrated |
| Dimension | 200 mm, 8" |
| Sales Unit | 20 pieces, sterile, single packed in dispenser box |



3/4

| BD671SU | SUSI Tissue Forceps |
|-------------|--|
| Name | WAUGHS |
| Description | 1 x 2 teeth |
| Dimension | 200 mm, 8" |
| Sales Unit | 20 pieces, sterile, single packed in dispenser box |



3/4



22 mm



28,6 mm



38 mm

| GK609SU | SUSI Bipolar Coagulation Forceps |
|-------------|---|
| Description | straight, w/o cable |
| Dimension | 200 mm, 8" tip width 1.5 mm |
| Sales Unit | 20 pieces, sterile, single packed in dispenser box |

| GK290SU – GK292SU | SUSI Bipolar Cable |
|-------------------|---|
| Dimension | 3.7 m |
| Pin Distance | 22 mm 28.6 mm 38 mm |
| Sales Unit | 10 pieces, sterile, single packed in dispenser box |

Aesculap® SUSI®

Single Use Surgical Instruments



| BH110SU | SUSI Mosquito Forceps |
|-------------|--|
| Name | HALSTED |
| Description | straight |
| Dimension | 125 mm, 4 7/8" |
| Sales Unit | 20 pieces, sterile, single packed in dispenser box |



| BH111SU | SUSI Mosquito Forceps |
|-------------|--|
| Name | HALSTED |
| Description | curved |
| Dimension | 125 mm, 4 7/8" |
| Sales Unit | 20 pieces, sterile, single packed in dispenser box |



| BH196SU | SUSI Haemostatic Forceps |
|-------------|--|
| Name | BIRKETT |
| Description | straight |
| Dimension | 185 mm, 7 1/4" |
| Sales Unit | 20 pieces, sterile, single packed in dispenser box |

| BH197SU | SUSI Haemostatic Forceps |
|-------------|--|
| Name | BIRKETT |
| Description | curved |
| Dimension | 185 mm, 7 1/4" |
| Sales Unit | 20 pieces, sterile, single packed in dispenser box |

Aesculap® SUSI®

Single Use Surgical Instruments



| BH424SU | SUSI Haemostatic Forceps |
|-------------|--|
| Name | PEAN |
| Description | straight |
| Dimension | 145 mm, 5 3/4" |
| Sales Unit | 20 pieces, sterile, single packed in dispenser box |



| BM235SU | SUSI Needle Holder |
|------------|--|
| Name | MAYO-HEGAR |
| Dimension | 150 mm, 6" |
| Sales Unit | 20 pieces, sterile, single packed in dispenser box |

| BM226SU | SUSI Needle Holder |
|------------|--|
| Name | CRILE WOOD |
| Dimension | 200 mm, 8" |
| Sales Unit | 20 pieces, sterile, single packed in dispenser box |

Aesculap® SUSI®

Single Use Surgical Instruments



3/4

| BV067SU | SUSI Self-Retaining Retractor |
|-------------|--|
| Name | WEITLANER |
| Description | semi-sharp, 3 x 4 teeth |
| Dimension | 130 mm, 5 1/8" |
| Sales Unit | 20 pieces, sterile, single packed in dispenser box |



3/4

| BT028SU | SUSI Retractor |
|-------------|--|
| Name | ROUX |
| Description | blade sizes 36 x 20 mm Et 20 x 15 mm |
| Dimension | 170 mm, 6 3/4" |
| Sales Unit | 20 pieces, sterile, single packed in dispenser box |



3/4



1/2

| FK850SU | SUSI Curette |
|-------------|--|
| Description | sharp, round workpiece 7 mm oval workpiece 9 x 6 mm |
| Dimension | 215 mm, 8 1/2" |
| Sales Unit | 20 pieces, sterile, single packed in dispenser box |

| OM760SU | SUSI Tonsil Snare |
|-------------|---|
| Name | EVES |
| Description | with 2 wire loops |
| Dimension | 285 mm, 11" |
| Sales Unit | 10 pieces, sterile, single packed in dispenser box |

Aesculap® SUSI®

Single Use Surgical Instruments



PACK PER CASE

| Product Code | Description | Page |
|--------------|----------------------------|------|
| 5061000 | Suture Set 1 | 4 |
| 5061010 | Surgical Dressing Set 1 | 4 |
| 5061020 | Surgical Dressing Set 2 | 5 |
| 5061030 | Surgical Dressing Set 3 | 5 |
| 5061040 | Suture Removal 1 | 6 |
| 5061050 | Suture Removal | 6 |
| 5062000 | Thorax Drainage Set, small | 7 |
| 5062010 | Thorax Drainage Set, large | 8 |
| 5062020 | Thorax Drainage Set | 9 |
| 5063000 | SUSI Port Set | 10 |
| 5063010 | SUSI Cardiac Pacemaker Set | 11 |
| 5063020 | SUSI Varicose Vein Set | 12 |
| AN915SU | SUSI Tubing Clamp | 16 |
| BC110SU | SUSI Fine Scissors | 18 |
| BC324SU | SUSI Surgical Scissors | 18 |
| BC606SU | SUSI Dissecting Scissors | 19 |
| BD047SU | SUSI Dissecting Forceps | 21 |
| BD222SU | SUSI Dissecting Forceps | 20 |
| BD239SU | SUSI Dissecting Forceps | 22 |



CLINIC LINE



| Product Code | Description | Page |
|-------------------------------|----------------------------------|------|
| BD512SU | SUSI Tissue Forceps | 20 |
| BD557SU | SUSI Tissue Forceps | 21 |
| BD671SU | SUSI Tissue Forceps | 22 |
| BF046SU | SUSI Sponge Forceps | 16 |
| BF047SU | SUSI Sponge Forceps | 17 |
| BF059SU | SUSI Sponge Forceps | 17 |
| BH110SU | SUSI Mosquito Forceps | 24 |
| BH111SU | SUSI Mosquito Forceps | 24 |
| BH196SU | SUSI Haemostatic Forceps | 25 |
| BH197SU | SUSI Haemostatic Forceps | 25 |
| BH424SU | SUSI Haemostatic Forceps | 26 |
| BM226SU | SUSI Needle Holder | 27 |
| BM235SU | SUSI Needle Holder | 27 |
| BT028SU | SUSI Retractor | 28 |
| BV067SU | SUSI Self-Retaining Retractor | 28 |
| FK850SU | SUSI Curette | 29 |
| GK290SU GK291SU GK292SU | SUSI Bipolar Cable | 23 |
| GK609SU | SUSI Bipolar Coagulation Forceps | 23 |
| OM760SU | SUSI Tonsil Snare | 29 |



